

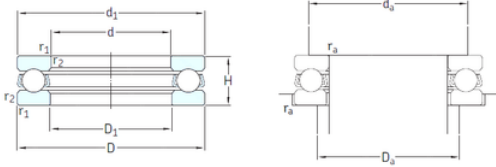

Bearing company



skf 51202 bearing

Bearing No. 51202

Size	15x32x12 mm
Bore Diameter	15 mm
Outer Diameter	32 mm
Width	12 mm
d	15 mm
D	32 mm
H	12 mm
d1	32 mm
r1 min.	0,6 mm
r2 min.	0,6 mm
D1	17 mm
da min.	25 mm
Da max.	22 mm
ra max.	0,6 mm
Weight	0,046 Kg
Basic dynamic load rating (C)	15,9 kN
Basic static load rating (C0)	25 kN
Fatigue load limit (Pu)	0,915
Reference speed	7000 r/min
Limiting speed	10000 r/min
Category	Thrust Ball Bearing
Inventory	0.0
Manufacturer Name	SKF
Minimum Buy Quantity	N/A
Weight / Kilogram	0.049
EAN	7316577058553

51202 Bearing 2D drawings and 3D CAD models



Bearing company

Product Group	B00308
Rolling Element	Ball Bearing
Thrust Bearing	Yes
Single or Double Direction	Single Direction
Banded	No
Cage Material	Steel
Precision Class	ABEC 1 ISO P0
Component Description	Roller Assembly Plus Raceways
Other Features	Single Row
Long Description	15MM Bore 1; 17MM Bore 2; 32MM Outside Diameter; 12MM Height; Ball Bearing; Single Direction; Not Banded; Steel Cage; ABEC 1 ISO P0 Precision
Inch - Metric	Metric
Category	Thrust Ball Bearings
UNSPSC	31171507
Harmonized Tariff Code	8482.10.50.08
Noun	Bearing
Keyword String	Ball Thrust
Manufacturer URL	http://www.skf.com
Manufacturer Item Number	51202
Weight / LBS	0.107
Bore 1	0.591 Inch 15 Millimeter
Bore 2	0.669 Inch 17 Millimeter
Outside Diameter	1.26 Inch 32 Millimeter
Height	0.472 Inch 12 Millimeter
Overall Height with Aligning Washer	0 Inch 0 Millimeter
bore diameter:	15 mm
static load capacity:	25 kN
outside diameter:	32 mm



Bearing company

dynamic load capacity:	15.9 kN
overall width:	12 mm
maximum rpm:	10000 RPM
thrust bearing type:	Single-Direction
cage material:	Steel
outside diameter design:	Straight
fillet radius:	0.6 mm
separable or banded:	Separable
series:	512
precision rating:	ABEC 1 (ISO Class Normal)
d_1	32 mm
D_1	17 mm
$r_{1,2}$ min.	0.6 mm
d_a min.	25 mm
D_a max.	22 mm
r_a max.	0.6 mm
Basic dynamic load rating C	15.9 kN
Basic static load rating C_0	25 kN
Fatigue load limit P_u	0.915 kN
Minimum load factor A	0.0038
Mass bearing (including seat washer where applicable)	0.046 kg